

DESCRIPTION

Model	MPB	150	B	A	D	A
No.	1	2	3	4	5	6
1	Series	MPB				
2	Flow	15.0L/min				
3	Body Material	A:304,B:316L,C:PPS,D:Hastelloy				
4	Gear/Shaft Material	A:PEEK(gear)+316(shaft), B:PEEK(gear)+Ceramic(shaft)				
5	Thread	A:G1/8", B:G1/4", C:G3/8", D:G1/2", E:G3/4", F:Cutomize				
6	Sealing Ring	A:FKM,B:PTFE				

Exploded View

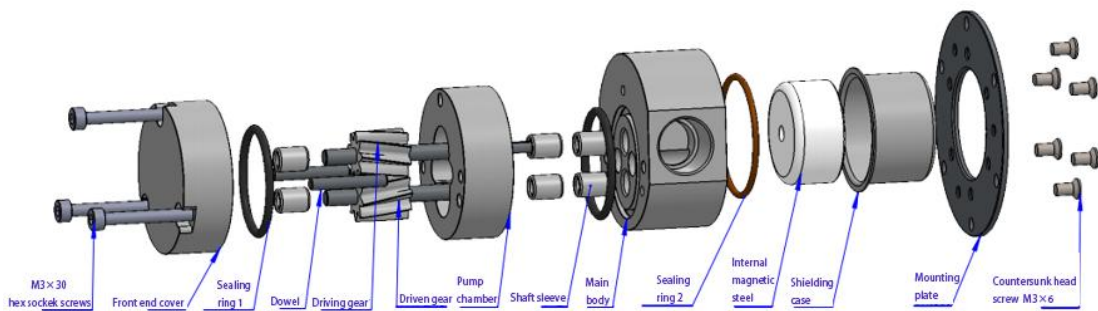

(From left to right)

- 1: M3×25 hex socket screws
- 2: Front end cover
- 3: Sealing ring1
- 4: Dowel
- 5: Driving gear
- 6: Driven gear
- 7: Pump chamber

- 8: Shaft sleeve
- 9: Main body
- 10: Sealing ring 2
- 11: Internal magnetic steel
- 12: Shielding case
- 13: Mounting plate
- 14: M3*6 pan head screws

Parameter	Parameter detail
Viscosity Range:	0~3000cps
Tempature Range:	-20°C~110°C
Pressure:	8Bar
Types of Media:	Except for strong acids and bases, almost all liquids.
Inlet Filter:	Recommended 400 mesh
Inlet vacuum level:	-0.85Bar

Advantages

- 1.Smooth Fluid Conveyance: Micro-magnetic gear ensures precise, pulse-free delivery (+/-0.5 %).
- 2.Powerful Vacuum Suction: Capable of high-pressure, smooth transfer in low-viscosity liquids.
- 3.Leak-Free Operation: Magnetic drive and static O-ring seal prevent leaks, ensuring isolation.
- 4.Convenient Maintenance: Sealed with O-rings for easy disassembly, cleaning, and durability.
- 5.Low-Noise Operation: Operating with minimal noise in comparison to others, our pumps offers an efficient and noise-conscious solutions.

Applications

Micro magnetic gear pumps find extensive applications across various industries.

- Medical
(Blood Dialysis Machines, Infusion Systems...)
- Food and Beverage
(Food Packaging Machinery, Liquid Ingredient Systems...)
- Automotive (Coolant Supply Systems...)
- Energy (Small-scale Lubrication Systems...)
- Environmental, Scientific Research, etc.